

YOUR BEST POWER SOURCE SOLUTIONS

FEATURE

- > **High Compression Cell Group**
 - Increased CCA Performance
- > **Absorbed Glass Mat (AGM)**
 - Increased Vibration Resistance
- > **Closed Loop Manufacturing**
 - No Unsafe Environmental Releases
- > **Factory Activated**
 - No Acid to Fill
 - 100% Capacity out of Box
- > **Sealed Design**
 - Considered Non-Hazardous By U.S. DOT
 - Shippable by Air Under IATA
- > **99.97% Primary Lead**
 - Increased Shelf Life
- > **Polypropylene Case and Cover**
 - For Applications Exposed to Oil & Gas

U1

SPECIFICATION

Cell per unit	6
Nominal Voltage (V)	12
Nominal Capacity (Ah)	16Ah @ 10hour rate F.V.(1.75/cell)
Weight	Approx6.03kg(13.29Lbs.)
Polarity:	
Acid Volume:	1400g
Charge Current :	1.6 Amps
C.C.A.:	220

DIMENSIONS	Length	Width	Height	Total Height
Unit: mm	197±1	130±1	159±1	170±1
Unit: inch	7.76±0.04	5.12±0.04	6.25±0.04	6.69±0.04

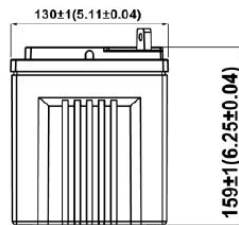
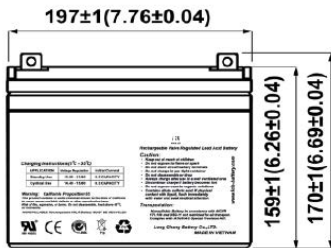

SELF DISCHARGE AND CAPACITY OF AGM BATTERIES

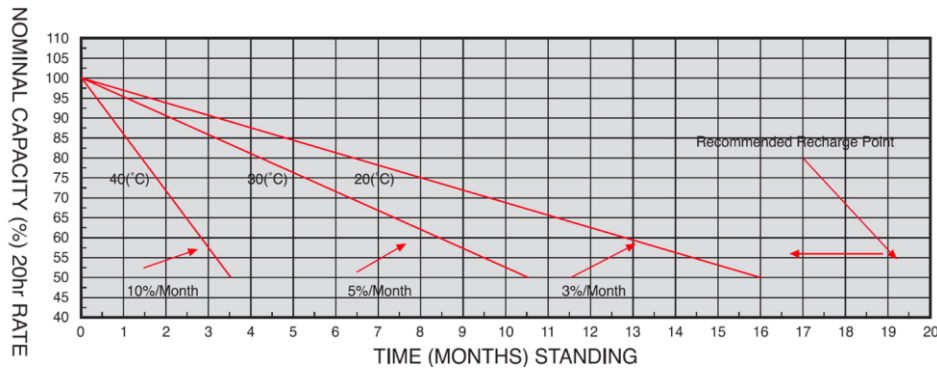

CAPACITY	VOLTAGE
100%	V > 13.0V
90%	12.80 < V < 13.00
80%	12.65 < V < 12.80
70%	12.50 < V < 12.65
60%	12.35 < V < 12.50
50%	12.20 < V < 12.35
40%	12.05 < V < 12.20
30%	11.90 < V < 12.05
20%	11.75 < V < 11.90
10%	11.60 < V < 11.75

RECOMMENDED CHARGING

CHARGING METHOD: VOLTAGE REGULATED

Vehicle Charging	Max Initial Current: less than 0.3C Voltage:14.40 V ~ 15.00 V at 25°C (77 °F)
Discharged Battery	Charging current: 0.1C, when charging voltage up to 14.40V, continue to charge 4h Estimated Charging time: 5 ~12h
Seasonal Maintenance Charging:	No limit on Initial charging current Voltage: 13.50 V ~ 13.80 V at 25°C (77 °F)

PART NAME	DRAWING NAME	SPECIFICATION	MATERIAL	HEIGHT	WIDTH	DEPTH	QUANTITY
BATTERY	59-U1-9S	U1-9S		130	197	177	1

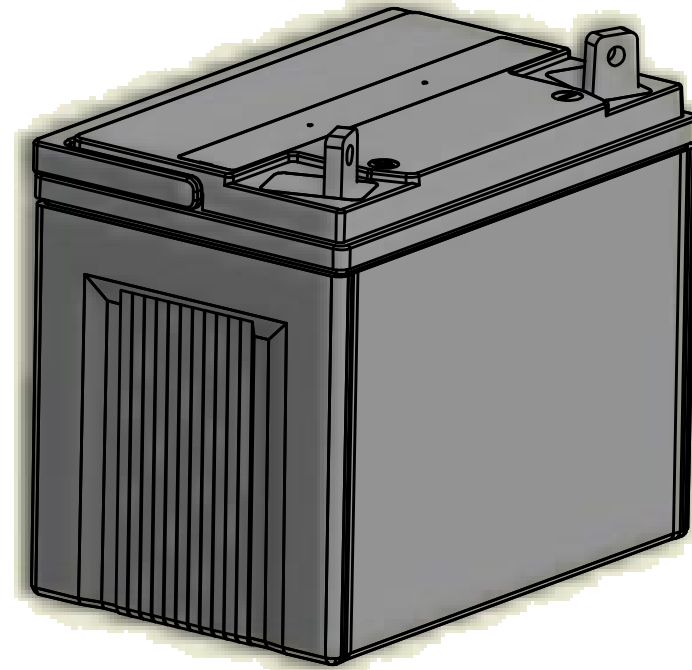
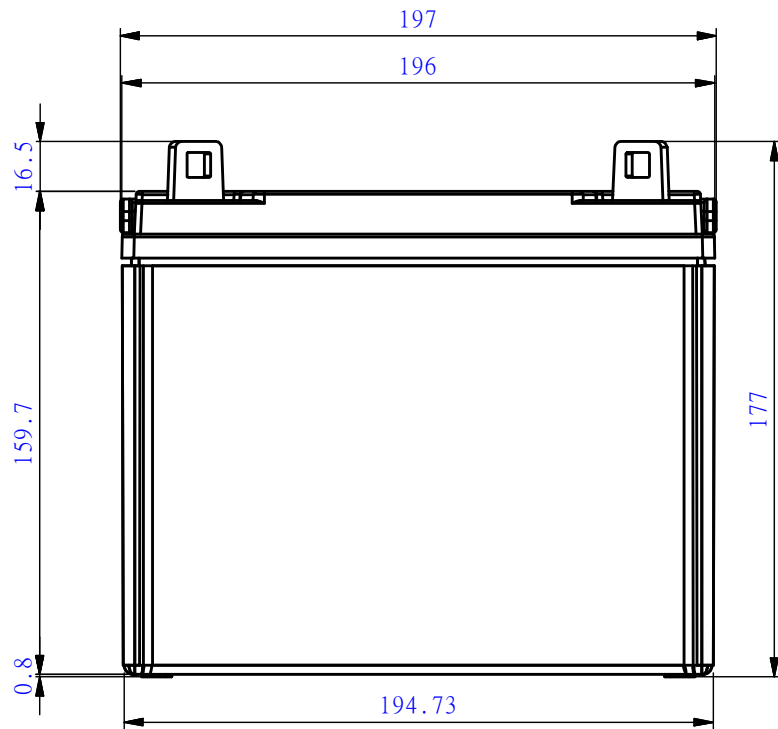
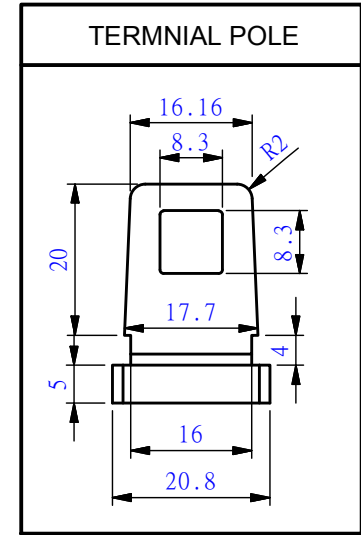
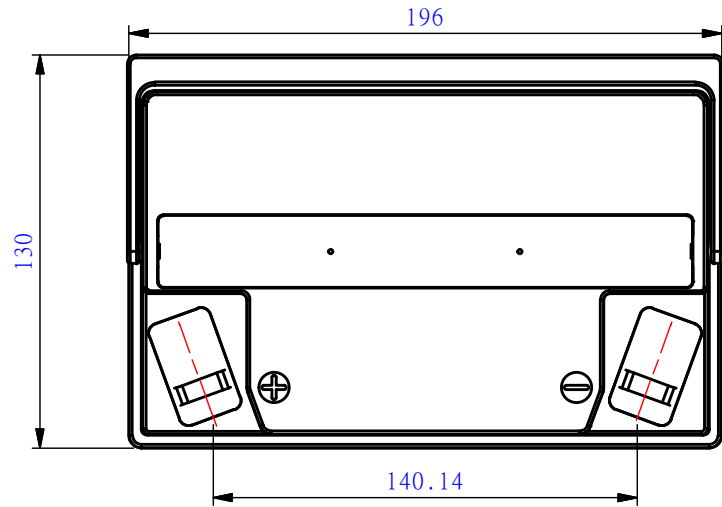

SCALE

UNIT
mm

APPROVAL

CHECKER

NOTE